

NexStar® VAULT



User's Manual

Model: NST-V290S2

Version : 1.0

1 Introduction

The Vantec NexStar® Vault is a portable security enclosure. With its simple-to-use keypad design, simply enter your 6-digit PIN to guard your data from unwanted access. Whether it is financial documents, passwords, or any type of sensitive materials, the NexStar® Vault will keep your data safe with its integrated encryption technology. The hard drive is formatted into two partitions; an open drive (Public) and a private drive (Vault). Store and share your files under the "Public" drive and keep your sensitive materials safely guarded in the "Vault". Simply connect the NexStar® Vault to any PC or Mac with an USB port—no drivers are required. Start protecting your valuable data with the Vantec NexStar® Vault!

Front View

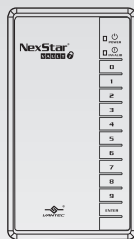

Rear View

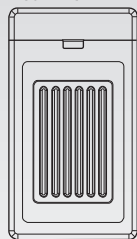

Top View



Specifications

Model: NST-V290S2
Host Interface: USB 2.0
Drive Supported: 2.5" SATA I/II
Storage Capacity: 500GB*
Dimensions: 130 x 75 x 16mm

Package Contents

- NexStar Vault
- USB Y-Cable
- Hard Carrying Case
- User Manual

System Requirements

Microsoft Windows® 2000/XP/Vista or Mac® OS X 10.4 or Greater
USB-equipped system with available USB port
For USB 2.0 speeds, the system must support USB 2.0 specifications.

2 Hardware Installation Guide

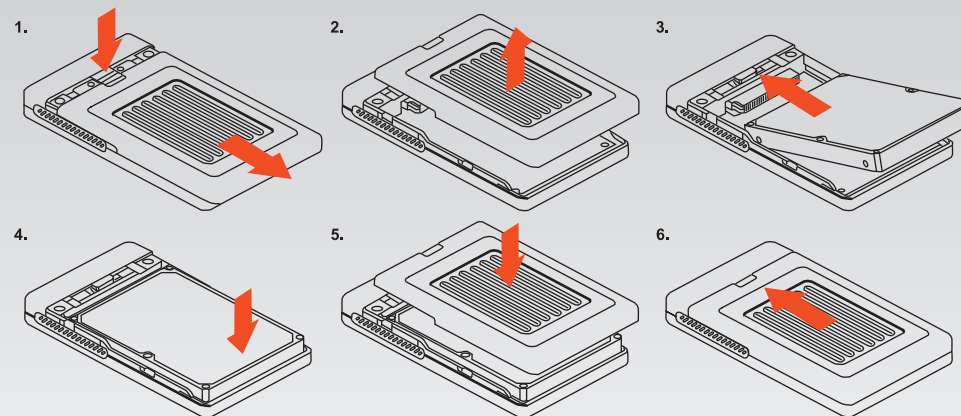

- Note:** 1. When the hard drive is installed in the NexStar® Vault for the first time, please make sure that no data is saved on the hard drive. Once the hard drive is connected to the computer/laptop, the NexStar® Vault will delete all data and format the drive with FAT32.
2. If you are using a hard drive previously installed in a NexStar® Vault, the data will be preserved. The private data can be accessed using the NexStar® Vault with the original PIN.

LED Indicator Status

Action & Status	Power LED/Access LED	INVALID LED
Power On	Blue Light ON	—
HDD Access	Blue Light & Pink Light ON	—
HDD Idle	Blue Light ON	—
Pressing Key	Blue Light ON	Light ON when the key is being pressed.
Correct PIN	Blue Light ON	Red Light blinks once
Invalid PIN	Blue Light ON	Red Light blinks for 5 seconds
PIN Change (Start & End)	Blue Light ON	Red Light blinks twice

3 How to Setup the Private "Vault"

After the hardware has been installed successfully and connected to the computer via a USB cable, the OS will detect your hard drive automatically. Once detected, the NexStar® Vault will automatically partition the hard drive within into two drives: one as a Public drive and the other as a hidden drive (Vault). Note that each drive is half the size of the original drive. Once the detection is completed by the OS, the Public drive is then ready to use.

1. Unlocking the "Vault"

Enter the 6-digit PIN and quickly press Enter to access the "Vault." (The default PIN sequence is 1,2,3,4,5 and 6)

- Note:** 1. Please note that after you enter the PIN, the NexStar® Vault will reset automatically. If data is being accessed from the Public drive during this process, this might result in data transmission failure or damage/creating abnormal data files.
2. During the PIN input, if the time interval between the inputs of two successive digits exceeds 10 seconds, the PIN will be considered invalid.
3. If a wrong PIN is entered, please re-enter the PIN after the Invalid LED has turned off.

2. Locking the "Vault"

To lock the "Vault", simply press the number "0" key and hold for 5 seconds. By doing this, your unit will reboot and the "Vault" will be hidden from view. Once locked the Public folder will only be accessible until the PIN is reentered. Also another way of locking your device would be to use the safely remove hardware/USB device method suggested by your operating system.

- Note:** Please note that after you press the number "0" key and hold for 5 seconds, the NexStar® Vault will automatically reboot itself. If data is being accessed from the Public or Vault drive during this process, this might result in data transmission failure or damage/creating abnormal data files.

4 PIN Setup

To setup your NexStar® Vault please follow the steps below to change the Personal Identification Number (PIN).

1. Enter the current PIN to access the "Vault".
2. Once access has been granted, press and hold the Enter key for 3 seconds. (Once the key has been released, the Invalid LED will blink twice.)
3. Enter the old PIN. (If the PIN entered is correct, the Invalid LED will blink once.)
4. Enter a new PIN. (Once the new PIN has been entered, the Invalid LED will blink once.)
5. Enter the new PIN once more. (After the new PIN is verified, the Invalid LED will blink twice.)
6. You have completed setting up your NexStar® Vault.

- Note:** 1. Please note that the new PIN must be 6 digits long. The numeric digits can be repeated. For example, 1, 2, 1, 2, 2 and 1 is a valid PIN sequence. However, a PIN with more or less than 6 digits will be considered invalid.
2. During the course of setting up the new PIN, if the old PIN is incorrectly entered, the setup will be canceled and the PIN will not be changed. The NexStar® Vault will revert back to the beginning of step 2.
3. During the PIN input, if the time interval between the inputs of two successive digits exceeds 10 seconds, the PIN will be considered invalid. The NexStar® Vault will revert back to the beginning of step 2.
4. There is no limit on the number of times a PIN can be inputted.
5. If a wrong PIN is entered, please re-enter the PIN after the Invalid LED turns off.

Notes

1. When you are using the NexStar® Vault for the first time, make sure to change the 6-digit PIN. (The Default PIN sequence is 1, 2, 3, 4, 5 and 6.)
2. When unlocking and locking the "Vault", the unit will reboot itself. Please make sure that no data is being accessed from the NexStar® Vault during the auto-reboot sequence to avoid data transmission failure or damage/creating abnormal data files.
3. If the hard disk was previously installed and used in a previous NexStar® Vault, the Public drive on the hard drive can still be accessed normally when plugged into a computer directly. However, data within the "Vault" will not be accessible and will show up as unformatted partition. To access the data within the "Vault" the hard drive must be accessed through a NexStar® Vault.
4. During the PIN input, if the time interval between the inputs of two successive digits exceeds 10 seconds, the PIN will be considered invalid. There is no limit on the number of times for invalid PIN inputs.
5. If the "Enter" key is pressed during PIN input, the PIN will be considered invalid.
6. If a wrong PIN is entered, please re-enter the PIN after the Invalid LED goes off.
7. The NexStar® Vault uses the standard USB Bus Power (5V/500mA).

8. The red USB connector is only to provide extra power to the NexStar® Vault. If only the red USB connector is connected to the computer, the NexStar® Vault will not function properly.



9. All information contained in this manual has been carefully confirmed before publication. Information are subject to change. For any updates on the product, please check our website www.vantecusa.com.

Warranty

The NexStar Vault comes with a 1 year limited warranty (90 day parts). If your unit should become defective within that time frame, please go to <http://www.vantecusa.com> for information on how to receive warranty exchange or repair. Cosmetic defects and missing parts are not covered under this warranty. Please check the contents of the unit to make sure you received all parts. Also, check for any cosmetic flaws. If any parts are missing or if there are cosmetic defects, please contact the retailer from which you purchased the unit immediately and ask for a replacement.