



# NexStar · CX

EXTERNAL 2.5" HARD DRIVE ENCLOSURE  
USB 2.0 INTERFACE

## Owner's Manual

Model: **NST-200S2-BK**

[www.vantecusa.com](http://www.vantecusa.com)

SATA to USB 2.0

All Registered Trademarks Belong To Their Respected Companies.

Copyright © 2007 Vantec Thermal Technologies. All Rights Reserved.

#### 1. Introduction

Vantec introduces its NexStar CX 2.5" External Hard Drive Enclosure. Ideal for anyone in need of portable storage, the NexStar's slim pocket design makes it a convenient way to carry your data. The NexStar CX turns any SATA 2.5" Hard Drive into a convenient hard drive that can be used on any system with a USB port. In addition, the aluminum casing protects the drive from overheating and vibration. The NexStar CX supports USB 1.1 and USB 2.0 to offer fast transfer speeds of up to 480Mbps. The Vantec NexStar CX 2.5" External Hard Drive Enclosure is great for anyone who requires a high performance, lightweight, and durable portable storage solution.

#### 2. System Requirements

Intel Pentium II 350 MHz Compatible or Mac G3 Processor & Greater  
Microsoft Windows 98SE/ME/2000/XP/Vista or Mac OS 8.6 & Greater USB-Equipped System  
For USB 2.0 Speeds, the System Must Support USB 2.0 Specifications

1

#### 3. Specifications/Features

##### Features :

- Aluminum Casing Cools Down Your Hard Drive.
- Transfer Rates Up to 480Mbps w/USB 2.0.
- Easily Add Storage to Any System with USB.
- Hot-Swappable: Plug & Play Without Rebooting.
- Attractive Blue LED Indicates Power & HDD Activity.

##### Specifications :

- Device Support : SATA I/II Hard Drive
- Device Size : 2.5"
- Internal Interface : SATA
- External Interface : USB 2.0
- Material : Aluminum
- Dimension : 135 x 82 x 13mm

##### Package Includes :

- 2.5" NexStar CX Enclosure
- USB Y-Cable
- User Manual
- Installation Screws

2

#### 3. Parts Layout

NexStar CX External 2.5" HDD Enclosure :

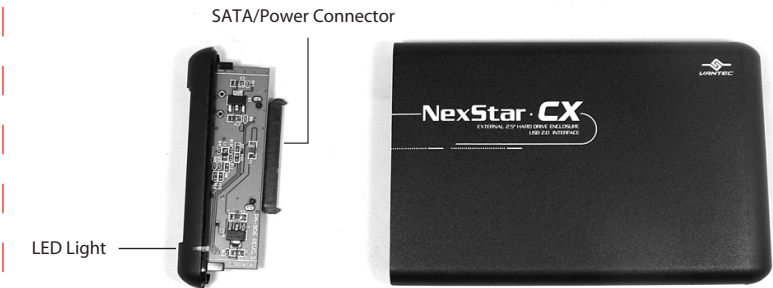

3

#### 4. Installation

4-1 Connect the 2.5" hard drive to the SATA/Power connector.

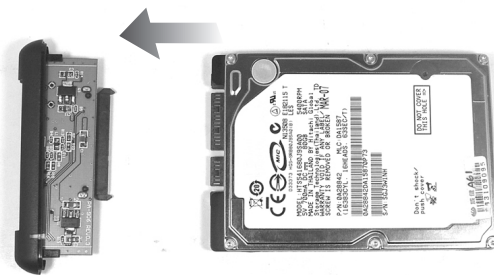

4

4-2 Insert the hard drive caddy back into the NexStar CX housing as the picture below. Be sure to align the caddy with the guides within the housing.



5

4-3 Secure the caddy to the housing using the screws provided.



6

#### 5. Warranty

The Nexstar CX comes with a 1 year limited warranty (90 day parts). If your unit become defective within that time frame, please go to <http://www.vantecusa.com> for information on how to receive warranty exchange or repair. Cosmetic defects and missing parts are not covered under this warranty. Please check the contents of the unit to make sure you received all parts. Also, check for any cosmetic flaws. If any parts are missing or if there are cosmetic defects, Please contact the retailer from which you purchased the unit immediately and ask for a replacement.

##### Vantec Thermal Technologies

43951 Boscell Rd.  
Fremont, CA 94538  
tel: 510-668-0368  
fax: 510-668-0367  
website: [www.vantecusa.com](http://www.vantecusa.com)

7